

# NORIOTA

**BUILT IN SERIES – Zero Clearance Design**  
Stainless Steel Door Easily Converts to Overlay Panel Ready



**CRESCENT CUBE**  
1.3 x 2 x 6 CM  
1/2 x 3/4 x 2-3/8 IN



Shown with custom wood overlay panel (not included)

## NUI15COPSS

### Cabinet

Cabinet Finish	Stainless steel
Door Style	Swing, right hinged (field reversible to left hinged)
Door Panel	Stainless steel, can be removed for installation of custom 19 mm (3/4 in) wood panel
Handle	1.9 cm (3/4 in) Diameter stainless steel
Hinge	Stainless steel with built-in door close assist to ensure door closure
Maximum Door Opening	135°, Door and handle will not hit adjacent cabinetry
Interior Color	White
Interior Light	No
Door Gasket	Black, magnetic, replaceable

### Electrical Data

Electrical	115V / 60Hz / 1Ph / 15A
Voltage Range	104V – 127V
Rated Current	
Ice Making /Harvest	1.9A/1.5A
Power Cord Length	180 cm (72 in)
Plug Type	NEMA 5-15P

### Warranty

5-year compressor (parts only), 1-year parts & labour

### FEATURES & BENEFITS

- **Door is Both Stainless Steel or Overlay Panel Ready:** Allows for custom 1.9 cm (3/4 in) panel overlays, giving you the flexibility to match your cabinetry or use the included stainless steel door
- **Rated for Outdoor Use:** Upgraded components and full stainless steel exterior that looks great with exceptional performance both indoors and outdoors
- **Zero-Clearance Design:** Achieves seamless, flush integration into any built-in setting, ensuring a clean, custom look
- **Keeps Ice Frozen with No Drain Required:** Provides flexibility to install in locations without access to a drain, only an incoming water line is needed
- **Simple and Efficient Ice Production:** Produces up to 11.4 kg (25 lb) per day, up to 4 times more than an average household refrigerator
- **Shallow Depth Design:** At only 48 cm (18.9 in) deep, installs in even narrow spaces where traditional units cannot
- **Integrated Water Filter:** Removes impurities and improves taste, easy to replace

INDOOR / OUTDOOR CRESCENT CUBE ICE MAKER - 15 IN

Technical Data	
Max. Ice Production - Air Temperature 21°C (70°F) / Water Temperature 10°C (50°F)	11.4 kg (25 lb) Per Day
Ice Storage Capacity	10 kg (22 lb) in Removable Bin
Controls	ON/OFF switch conveniently located behind door
Sabbath Mode	No
Defrost Type	Manual
Refrigerant	R600a

Installation	
Ambient Temp. Operating Range	10 °C – 43 °C (50 °F - 110 °F)
Water Temp. Operating Range	5 °C - 32 °C (41 °F - 90 °F)
Water Pressure Operating Range	20-80 PSI (0.138MPa-0.55MPa) (Above 80 requires a regulator)
Installation Type	Built-in or freestanding
Anti-tip Bracket	Not required
Built-In Installation Type	Inset, frameless - Overlay and framed cabinet styles
Ventilation	Front breathing - No additional clearance required around the sides, minimal clearance required in rear
Water Inlet Connection	1/4" Compression fitting
Drain Connection	Ice stays frozen, no drain required

Dimensions	
Unit Dimensions (Including Feet and Hinge)	37.8 x 48 x 85.5 - 88 cm (14.9 x 18.9 x 33.7 - 34.7 in)
Net Weight	29.5 kg (65 lb)
Toe Kick Height	10.2 cm (4 in)
Adjustable Leveling Feet	1.6-4.2 cm (0.6-1.7 in)
Shipping Dimensions	46.2 x 53.7 x 96.5 cm (18.1 x 21.1 x 38 in)
Shipping Weight	35.7 kg (78 lb)
Cut-Out Dimensions	38.1 x 45.7-61 x 85.5-88 cm (15 x 18-24 x 33.7-34.7 in)

Accessories Included	
Ice scoop with holder, ice bin	

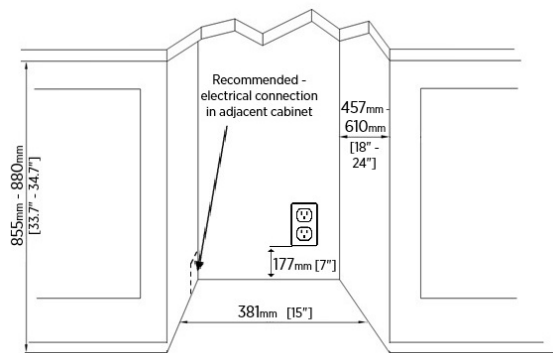
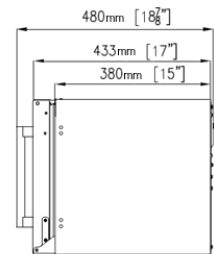
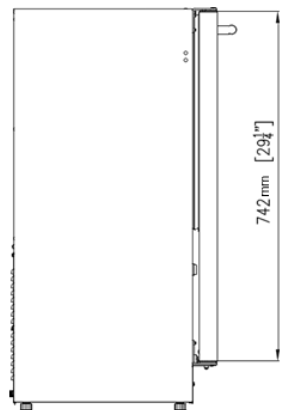
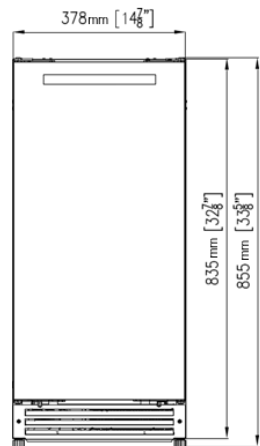

N  
O  
R  
I  
O  
T  
A